

American Oak

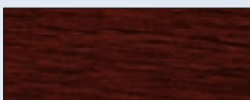

Georgian Cherry

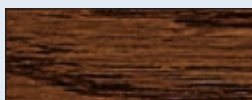

Antique Walnut

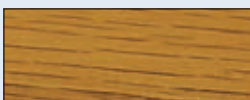

Golden Pine

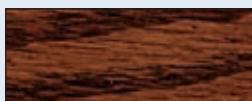

Brown Mahogany



Java

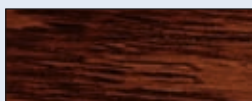

Candlelite



New Pine

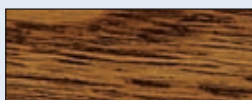

Colonial Maple

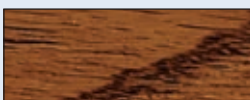

Nutmeg

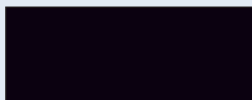

Black

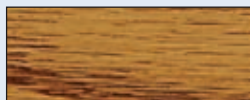

Prairie Wheat

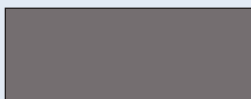

Gray

GEL STAIN
&
TOPCOAT



Gel Finishes

BY GENERAL FINISHES

Wipe on Urethane Stains & Topcoats

General Finishes Gel Stains and Topcoat have been formulated to produce a beautiful hand-rubbed finish. These easy to use products simply wipe on with a rag. There's no messy splashing, drips or runs. Gel stains produce an even finish on hard to stain woods such as Cherry, Pine or Maple.

Application of Gel Stains:

On bare wood using a cloth, foam brush or paint pad applicator, apply a liberal amount of GEL STAIN to the area you are working. Divide your project into sections, drawer front, table or cabinet top, side of chest, etc. Then using a clean cloth wipe off the excess stain in the direction of the grain. Be sure to remove all rag marks and smudges. Additional coats of stain may be applied for a deeper, richer color.

Optional:

Due to the high content of urethane in Gel Stains, they may be used by themselves as a one can finish. They can also be applied over existing finishes to enhance the finish or to change the color. The surface must be cleaned and lightly sanded before applying the Gel Stains. We recommend applying 2-3 coats with a minimum of 24 hours between coats. Allow the last coat to dry 48 hours before applying Gel Satin or GF High Performance Water Based Topcoat for added durability.

Application of Gel Topcoats:

Using a cloth, foam brush or paint pad applicator, apply a liberal amount of GEL TOPCOAT. Wipe off the excess evenly with the grain. Make sure to wipe off any smudges or rag marks. We recommend 2-3 coats.

Dry Time: Good Conditions 12-24 hours.
Cold or Damp Conditions 24 hours.

Clean Up: Mineral Spirits or Waterless Hand Cleaner

Coverage: 200 ft²/quart or 4.92 m²/liter

Warranty: General Finishes' products should be tested to your complete satisfaction before using. General Finishes will be responsible for only the replacement cost of the product and not for any other cost such as labor, damage cost or replacement cost.

General Finishes, East Troy, WI

www.generalfinishes.com

Made in the USA